

# 1000 (light gray) Series

## 1000 (light gray)

### Features

- Slim and lightweight
- Campucka coupling can be used

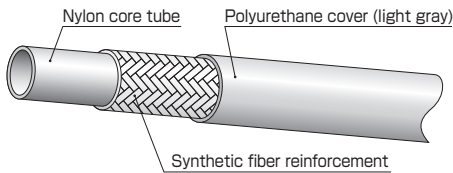

Part No.	Size			Max. working pressure		Min. burst pressure		Min. bending radius (mm)	Weight (g/m)	Coupling	
	Size No.	I.D. (in.)	I.D. (mm)	O.D. (mm)	(MPa)	(PSI)	(MPa)				(PSI)
1000-04-LGY	04	1/4	6.3	10.4	10.5	1,500	42.0	6,000	30	64	Campucka Swage
1000-06-LGY	06	3/8	9.5	14.0	10.5	1,500	42.0	6,000	60	90	
1000-08-LGY	08	1/2	12.7	17.4	10.5	1,500	42.0	6,000	80	131	

**⚠ CAUTION :** If you use Campucka, the maximum working pressure for Campucka must be applied.

- Appropriate fluid : mineral general operating oil
- Working temperature range : -40 to +100°C

**🔧** If you use Campucka, the working temperature range for Campucka must be applied.

- Length in a unit package : 100m

**🔧** Suitable hose coupling is the same as that for the 1000 series.

**🔧** Color code "LGY" stands for light gray.

# [Campucka type] Hydraulic push-one coupling

(For 1000 (light gray))

## CE

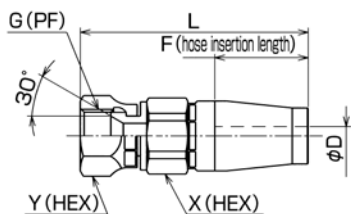

Part No.	G	Min. I.D. φD	F	L	X	Y	Weight (g)
CE-G-04-14L	1/4	3.5	26.0	64	19	19	85
CE-G-06-14L	3/8	6.0	29.0	72	22	22	115
CE-G-08-14L	1/2	9.0	35.0	83	27	27	205

- ⚠ **CAUTION** : If you use Campucka, the maximum working pressure for Campucka must be applied.
- ⚠ **CAUTION** : Handle with care not to drop couplings as an inner nipple could be self locked by pushing-out action to inlet of coupling.
- Material : steel
- Maximum working pressure : 10.5MPa
- Working temperature range : -20 to +100℃
- Adapter : 010, 045, 090, 150, 020, 025, 064, 069, 030

Assembling method  
▶▶▶ p.57

## Features of Campucka and assembly mechanism

### 1 Push-one connection

- Reduction of operation time (half that of our conventional product)
- Specialized swaging tool is not necessary. (Easy handling)
- Best for on-site length adjustment.
- Convenient for emergency repair.

### 2 Detachable hose

### 3 Correcting hose's twisted direction

- Hose is detachable for length adjustment when piping.
- Detachable tool is available.
- ⚠ **CAUTION** : Cannot be detached after pressurization.

### 4 Nipple stop mechanism

- It is possible to correct the twisted direction of a hose.
- ⚠ **CAUTION** : Cannot be detached after pressurization.

- Ratchet mechanism of our original locking ring is employed.
- Steady performance even for movable piping.
- Pressure variation is accommodated.

### Campucka assembly mechanism

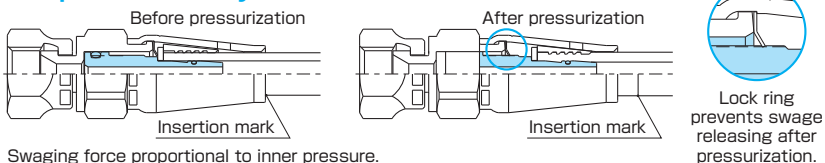

# [Swage type]

## SE

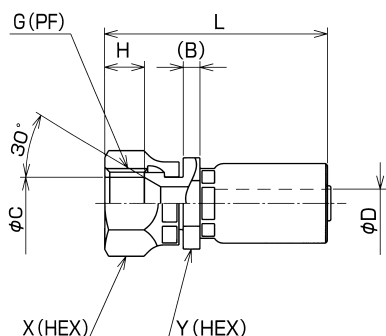

Part No.	Size No.	G	B	C	Min. I.D. φD	H	L	X (HEX)	Y (HEX)	Weight (g)	Pusher	Die
SE-PF-04-14	04	1/4	4.0	9.3	3.5	8.0	49	19	17	55	PSE14-04	SP14-04
SE-PF-06-14	06	3/8	4.0	12.3	6.8	9.5	53	22	19	75	PSE14-06	SP14-06
SE-PF-08-14	08	1/2	4.5	16.0	9.5	12.0	61	27	24	125	PSE14-08	SP14-08

- Material : steel
- Adapter : 010, 045, 090, 150, 020, 025, 064, 069, 030
- 🔗 Applicable hose couplings are the same as those for 1000 series.