

Q.D.C. 103 Series

Micro size coupler for air and oil pressure

Features

- **Push-To-Connect type**
One-touch connection just by pushing the nipple into the coupler.
- **Automatic opening/closing valve inside the coupler**
The valve inside the coupler is automatically opened by connecting the coupler and the nipple.
- **Smaller than 101 series**
Bamboo-shoot fitting integrated type available for direct connection to U5 tubing.
- **Electroless nickel plated**
Prevents degradation of surface and dissolution of copper ions into fluid.

Cross-sectional structure diagram

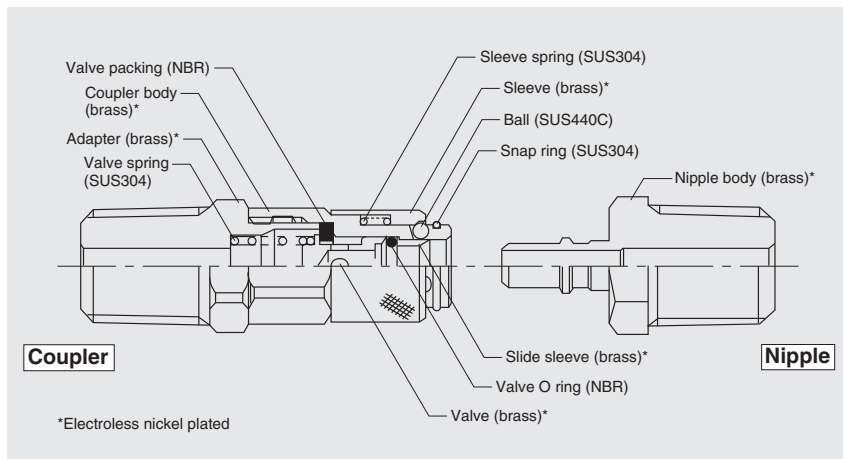

Operating fluid, working temperature range

Operating fluid	Working temperature range
Air	-20°C~+80°C
Water	0°C~+80°C
General operating oil	-20°C~+80°C

Pressure condition

Maximum working pressure: 1.0MPa
Negative pressure performance: -99.975kPa

Handling instructions

- ⚠ **Caution:** When working conditions of tubes and fittings are different, use them under the lower specified conditions.
- ⚠ **Caution:** Neither the coupler nor nipple can be connected to other manufacturers' products.
- ⚠ **Caution:** Detach the tubing, coupler or nipple in an unpressurized state.
- ⚠ **Caution:** Do not use and rotate coupler as a substitute for rotary joint or swivel joint.
- ⚠ **Caution:** When water is used as the operating fluid, do not allow it to freeze.
- ⚠ **Caution:** Do not use the coupler or nipple in a place contaminated with metal particles or dust. It could cause problems with operation.
- ⚠ **Caution:** Connection and disconnection under residual pressure may cause an accident. Also, do not hit the front end with a hammer to release pressure.
- ⚠ **Caution:** In case of leakage due to abrasion or degradation of O ring, replace both the O ring and body with new ones.

👉 See page 134 for the common handling instructions for the control, switch and detachable series products.

Product number example

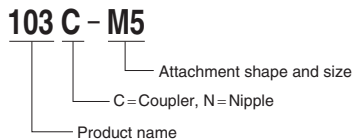

Coupler

Connector type

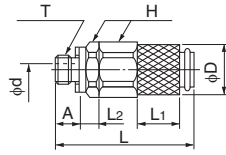

Product number	T Thread size (M)	L (mm)	L ₁ (mm)	L ₂ (mm)	A (mm)	H Width across flat (mm)	D (mm)	d (mm)	Weight (g)
103C-M5	M5x0.8	25.0	8.0	2.5	4.0	9.0	9.5	2.5	8.0

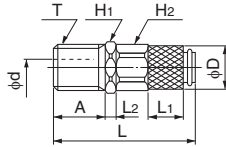

Product number	T Thread size (R)	L (mm)	L ₁ (mm)	L ₂ (mm)	A (mm)	H ₁ Width across flat (mm)	H ₂ Width across flat (mm)	D (mm)	d (mm)	Weight (g)
103C-2M	R1/8	31.0	8.0	3.0	11.0	10.0	9.0	9.5	3.0	13.0

Elbow type

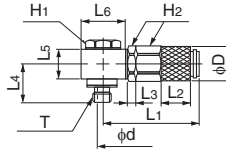

Product number	T Thread size (M)	L ₁ (mm)	L ₂ (mm)	L ₃ (mm)	L ₄ (mm)	L ₅ (mm)	L ₆ (mm)	H ₁ Width across flat (mm)	H ₂ Width across flat (mm)	D (mm)	d (mm)	Weight (g)
103C-M5UL	M5x0.8	26.0	8.0	2.5	10.0	8.0	12.0	8.0	9.0	9.5	2.0	15.0

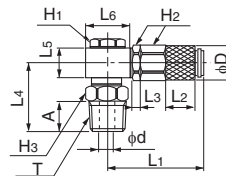

Product number	T Thread size (R)	L ₁ (mm)	L ₂ (mm)	L ₃ (mm)	L ₄ (mm)	L ₅ (mm)	L ₆ (mm)	A (mm)	H ₁ Width across flat (mm)	H ₂ Width across flat (mm)	H ₃ Width across flat (mm)	D (mm)	d (mm)	Weight (g)
103C-2MUL	R1/8	26.0	8.0	2.5	19.0	8.0	12.0	8.5	8.0	9.0	10.0	9.5	4.2	21.0

U5-tubing dedicated barb type

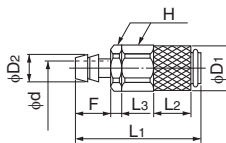

Product number	Applicable tubing type	L ₁ (mm)	L ₂ (mm)	L ₃ (mm)	F (mm)	H Width across flat (mm)	D ₁ (mm)	D ₂ (mm)	d (mm)	Weight (g)
103C-25H	U5-4x2.5	26.0	8.0	2.5	6.5	9.0	9.5	3.5	1.5	7.5
103C-40H	U5-4-6x4	27.5	8.0	2.5	8.0	9.0	9.5	5.7	3.0	8.0

U5-tubing dedicated barb elbow type

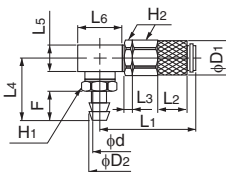

Product number	Applicable tubing type	L ₁ (mm)	L ₂ (mm)	L ₃ (mm)	L ₄ (mm)	L ₅ (mm)	L ₆ (mm)	F (mm)	H ₁ Width across flat (mm)	H ₂ Width across flat (mm)	D ₁ (mm)	D ₂ (mm)	d (mm)	Weight (g)
103C-25HL	U5-4-4x2.5	26.0	8.0	2.5	16.0	8.0	12.0	6.5	8.0	9.0	9.5	3.5	1.5	15.0
103C-40HL	U5-4-6x4	26.0	8.0	2.5	17.5	8.0	12.0	8.0	8.0	9.0	9.5	5.7	3.0	15.5

Tubing
Clean tubing
Processed tubing
PushOne fitting
QuickSeal fitting
Clean fitting/Chemifit
Bamboo-shoot fitting
Control switch/Detachable series
Jig/Tool/Accessory
Technical information
Reference

Nipple

Connector type

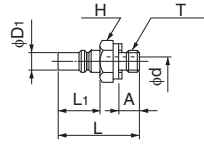

Product number	T Thread size (M)	L (mm)	L ₁ (mm)	A (mm)	H Width across flat (mm)	D ₁ (mm)	d (mm)	Weight (g)
103N-M5	M5x0.8	17.5	9.0	4.0	8.0	3.5	2.5	2.5

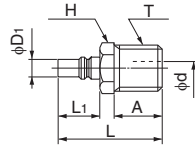

Product number	T Thread size (R)	L (mm)	L ₁ (mm)	A (mm)	H Width across flat (mm)	D ₁ (mm)	d (mm)	Weight (g)
103N-2M	R1/8	23.0	9.0	11.0	10.0	3.5	3.0	8.0

Elbow type

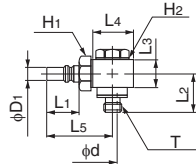

Product number	T Thread size (M)	L ₁ (mm)	L ₂ (mm)	L ₃ (mm)	L ₄ (mm)	L ₅ (mm)	H ₁ Width across flat (mm)	H ₂ Width across flat (mm)	D ₁ (mm)	d (mm)	Weight (g)
103N-M5UL	M5x0.8	9.0	10.0	8.0	12.0	18.5	8.0	8.0	3.5	2.0	9.5

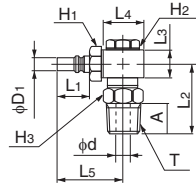

Product number	T Thread size (R)	L ₁ (mm)	L ₂ (mm)	L ₃ (mm)	L ₄ (mm)	L ₅ (mm)	A (mm)	H ₁ Width across flat (mm)	H ₂ Width across flat (mm)	H ₃ Width across flat (mm)	D ₁ (mm)	d (mm)	Weight (g)
103N-2MUL	R1/8	9.0	19.0	8.0	12.0	18.5	8.5	8.0	8.0	10.0	3.5	4.2	15.5

U5-tubing dedicated barb type

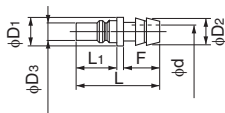

Product number	Applicable tubing type	L (mm)	L ₁ (mm)	F (mm)	D ₁ (mm)	D ₂ (mm)	D ₃ (mm)	d (mm)	Weight (g)
103N-25H	U5-4-4x2.5	17.0	9.0	6.5	6.0	3.5	3.5	1.5	1.0
103N-40H	U5-4-6x4	18.5	9.0	8.0	6.0	5.7	3.5	3.0	1.5

U5-tubing dedicated barb elbow type

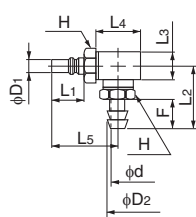

Product number	Applicable tubing type	L ₁ (mm)	L ₂ (mm)	L ₃ (mm)	L ₄ (mm)	L ₅ (mm)	F (mm)	H Width across flat (mm)	D ₁ (mm)	D ₂ (mm)	d (mm)	Weight (g)
103N-25HL	U5-4-4x2.5	9.0	16.0	8.0	12.0	18.5	6.5	8.0	3.5	3.5	1.5	9.5
103N-40HL	U5-4-6x4	9.0	17.5	8.0	12.0	18.5	8.0	8.0	3.5	5.7	3.0	10.0

Tubing

Clean tubing

Processed tubing

PushOne fitting

QuickSeal fitting

Clean fitting/Chemifit

Bamboo-shoot fitting

Control switch/Detachable series

Jig/Tool/Accessory

Technical information

Reference