

Miniature Valve

PushOne™ Type and QuickSeal Type

Features

- Easy flow rate control
Easy operation with large handle.
- Fine control of flow rate
Fine thread is used for valve system.
- PushOne connection for millimeter size type
Jigs and tools are not required for connecting the tubes.



Product number example

E MVB 6 - PT1/8

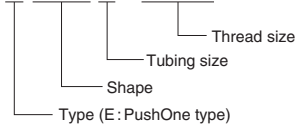

Q MVB 1N 1/4 - R1/8

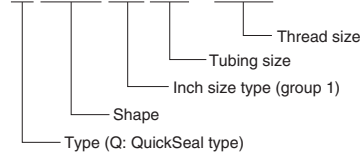

Operating fluid, working temperature range

Operating fluid	Working temperature range
Air	-20°C~+80°C
Water	0°C~+40°C

Pressure condition

Maximum working pressure: 1.0MPa
Negative pressure performance: -98.642kPa

Handling instructions

- ⚠ **Caution:** When the working conditions of tubes and fittings differ, use them under the lower specified conditions.
- ⚠ **Caution:** When water is used as the operating fluid, do not allow it to freeze.
- ⚠ **Caution:** Do not bend the pipe sharply near the tubing insertion port (sleeve end) of the fitting. Keep the tubing straight for twice as long as the tubing diameter from the insertion port.
- ⚠ **Caution:** The miniature valve has a determined flow direction, which is indicated on the side body. Flow fluid in the correct direction to control the flow rate.

📖 See page 134 for the common handling instructions for control, switch and detachable series products.

Applicable tubing

PushOne type (millimeter size)

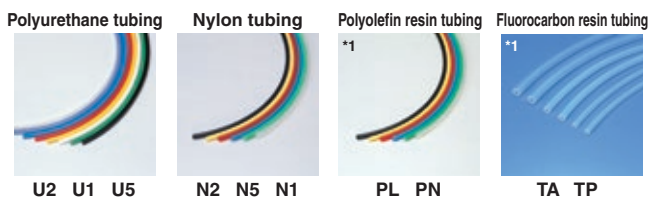

(*1) Combinatory use of PL, PN, TA or TP tubing and miniature valve mixes general and clean type performances. When using them together in a clean environment, be aware of how this could lower the cleanliness level.

QuickSeal type (Inch size)

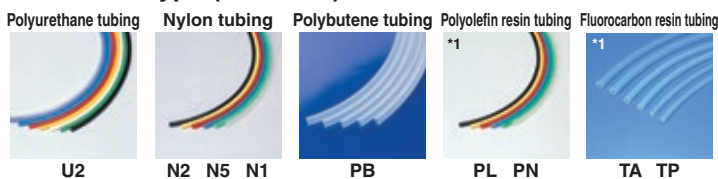

(*1) Combinatory use of PL, PN, TA or TP tubing and miniature valve mixes general and clean type performances. When using them together in a clean environment, be aware of how this could lower the cleanliness level.

Reference

Negative-pressure performance list.....P.169

Miniature Valve (PushOne™ type)

Inline type

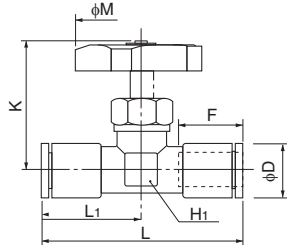

●Millimeter size type

Product number	Applicable tubing outer diameter (mm)	L (mm)	L ₁ (mm)	K		M (mm)	F Tubing insertion length (mm)	H ₁ Width across flat (mm)	D (mm)	Weight (g)	Effective sectional area (mm ²)
				Full open (mm)	Full closed (mm)						
EMVA6	6	50.6	25.3	39.9	35.9	40.0	15	15.0	15.0	—	—
EMVA8	8	51.6	25.8	39.9	35.9	40.0	16	15.0	15.0	86.0	2.5

Straight type

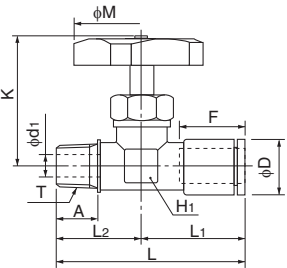

●Millimeter size type

Product number	Applicable tubing outer diameter (mm)	T Thread size (R)	L (mm)	L ₁ (mm)	L ₂ (mm)	A (mm)	K		M (mm)	F Tubing insertion length (mm)	H ₁ Width across flat (mm)	d ₁ (mm)	D (mm)	Weight (g)	Effective sectional area (mm ²)
							Full open (mm)	Full closed (mm)							
EMVB6-PT1/8	6	R1/8	46.8	25.3	21.5	10.0	39.9	35.9	40.0	15	15.0	5.0	15.0	81.0	3.5
EMVB6-PT1/4	6	R1/4	49.8	25.3	24.5	13.0	39.9	35.9	40.0	15	15.0	7.0	15.0	84.5	3.5
EMVB8-PT1/4	8	R1/4	50.3	25.8	24.5	13.0	39.9	35.9	40.0	16	15.0	7.0	15.0	—	—

Angled type

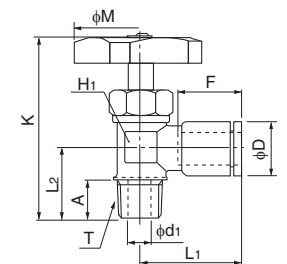

●Millimeter size type

Product number	Applicable tubing outer diameter (mm)	T Thread size (R)	L ₁ (mm)	L ₂ (mm)	A (mm)	K		M (mm)	F Tubing insertion length (mm)	H ₁ Width across flat (mm)	d ₁ (mm)	D (mm)	Weight (g)	Effective sectional area (mm ²)
						Full open (mm)	Full closed (mm)							
EMVC6-PT1/8	6	R1/8	25.3	23.0	12.0	57.9	53.9	40.0	15	15.0	5.0	15.0	76.5	7.0
EMVC6-PT1/4	6	R1/4	25.3	23.0	12.0	57.9	53.9	40.0	15	15.0	7.0	15.0	—	—
EMVC8-PT1/4	8	R1/4	24.8	23.0	12.0	57.9	53.9	40.0	16	15.0	7.0	15.0	78.0	7.0

Tubing

Clean tubing

Processed tubing

PushOne fitting

QuickSeal fitting

Clean fitting/Chemifit

Bamboo-shoot fitting

Control switch/Detachable series

Jig/Tool/Accessory

Technical information

Reference

Miniature Valve (QuickSeal type)

Inline type

●Inch size type



Product number	Applicable tubing outer diameter (inch)	L (mm)	L ₁ (mm)	K		M (mm)	S (mm)	F Tubing insertion length (mm)	H ₁ Width across flat (mm)	H ₂ (mm)	d ₂ (mm)	Weight (g)	Effective sectional area (mm ²)
				Full open (mm)	Full closed (mm)								
QMVA1N1/4	1/4	54.2	27.1	37.4	33.4	φ40.0	4.6	15	14.0	12.0	3.4	80.0	5.0
QMVA1N3/8	3/8	62.6	31.3	38.9	34.9	φ40.0	4.6	17	17.0	17.0	5.7	117.0	6.0

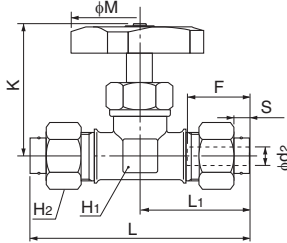

Straight type

●Inch size type



Product number	Applicable tubing outer diameter (inch)	T Thread size (R)	L (mm)	L ₁ (mm)	L ₂ (mm)	A (mm)	K		M (mm)	S (mm)	F Tubing insertion length (mm)	H ₁ Width across flat (mm)	H ₂ (mm)	d ₁ (mm)	d ₂ (mm)	Weight (g)	Effective sectional area (mm ²)
							Full open (mm)	Full closed (mm)									
QMVB1N1/4-R1/8	1/4	R1/8	46.6	27.1	19.5	10.0	37.4	33.4	φ40.0	4.6	15	14.0	12.0	5.0	3.4	76.0	5.0
QMVB1N1/4-R1/4	1/4	R1/4	48.6	27.1	21.5	12.0	37.4	33.4	φ40.0	4.6	15	14.0	12.0	7.0	3.4	95.0	5.5
QMVB1N3/8-R1/4	3/8	R1/4	56.3	31.3	25.0	12.0	38.9	34.9	φ40.0	4.6	17	17.0	17.0	7.0	5.7	113.0	6.0

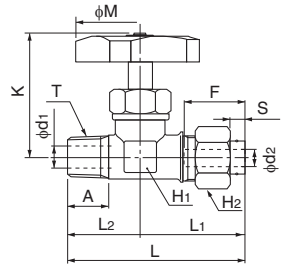

Angled type

●Inch size type



Product number	Applicable tubing outer diameter (inch)	T Thread size (R)	L ₁ (mm)	L ₂ (mm)	A (mm)	K		M (mm)	S (mm)	F Tubing insertion length (mm)	H ₁ Width across flat (mm)	H ₂ (mm)	d ₁ (mm)	d ₂ (mm)	Weight (g)	Effective sectional area (mm ²)
						Full open (mm)	Full closed (mm)									
QMVC1N1/4-R1/8	1/4	R1/8	27.1	20.0	10.0	54.9	50.9	φ40.0	4.6	15	14.0	12.0	5.0	3.4	75.0	—
QMVC1N1/4-R1/4	1/4	R1/4	27.1	22.0	12.0	56.9	50.9	φ40.0	4.6	15	14.0	12.0	7.0	3.4	92.0	7.0
QMVC1N3/8-R1/4	3/8	R1/4	28.3	23.0	12.0	59.9	55.9	φ40.0	4.6	17	17.0	17.0	7.0	5.7	104.0	7.0

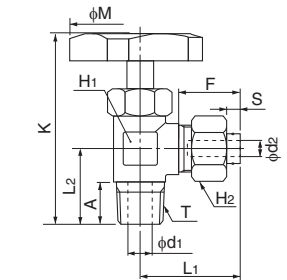

Tubing
Clean tubing
Processed tubing
PushOne fitting
QuickSeal fitting
Clean fitting/Chemifit
Bamboo-shoot fitting
Control switch/Detachable series
Jig/Tool/Accessory
Technical information
Reference